

OREGON PUBLIC LAND CORNER REPORT/RESTORATION REPORT
Tillamook County Surveyor's Office

SECTION: 12, 13, 7, 18 TOWNSHIP: 3N RANGE: 8W AND 7W
COUNTY: TILLAMOOK DATE: SEPT. 18, 2015

CORNER DESIGNATION: SECTION CORNER COMMON TO SECTIONS 7 & 18, T3N, R7W AND SECTIONS 12 & 13, T3N, R8W	(Please Check One)	
	<input type="checkbox"/>	Condition Report Only
	<input type="checkbox"/>	Restoration
	<input checked="" type="checkbox"/>	Rewitness
	<input type="checkbox"/>	Not Found
	<input type="checkbox"/>	Reset
<input type="checkbox"/> Referenced Out		

Previous Rewitnesses, Restorations, Surveys, etc.:

Found Monument(s) and Accessories(Condition & Source):

FOUND OREGON STATE BOARD OF FORESTRY BRASS CAP ON 1 1/2" GALVANIZED IRON PIPE STAMPED "T3N R8W R7W S12 S7 S13 S18 1956 RS359", 0.3' ABOVE GROUND, FROM WHICH: 35" ROTTEN FIR STUMP, NO SCRIBING VISABLE, BEARS (N 89 1/2° E 49.8'); 44" ROTTEN FIR STUMP WITH SCRIBING VISABLE BEARS (N 25° W 62.5'); 48" ROTTEN FIR STUMP WITH SCRIBING VISABLE BEARS (S 12 1/2° W 54.4'); 38" ROTTEN FIR STUMP, NO SCRIBING VISABLE, BEARS (N 62° E 71.8'); NO EVIDENCE OF ORIGINAL GLO BEARING TREES LEFT, SEE REWITNESS BOOK 1, PAGE 263.

Monument Set(Procedures & Description):

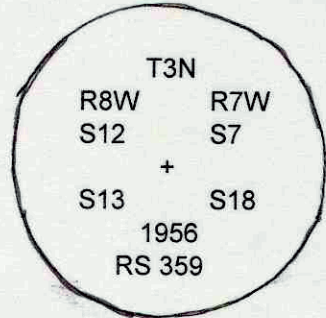

Other New Accessories Set:

CARSONITE POST 1.5' NORTH

New Bearing Trees:

20" DUG FIR SCRIBED "T3N R7W S7 BT" BEARS N 84° E 11.15 FEET TO BRASS NAIL AND WASHER "LS 2507" BETWEEN THE B AND T; 24" DUG FIR SCRIBED "T3N R7W S18 BT" BEARS S 23° E 5.80 FEET TO BRASS NAIL AND WASHER "LS 2507" BETWEEN THE B AND T; 18" DUG FIR SCRIBED "T3N R8W S13 BT" BEARS S 44° W 51.70 FEET TO BRASS NAIL AND WASHER "LS 2507" BETWEEN THE B AND T; 14" DUG FIR SCRIBED "T3N R8W S12 BT" BEARS N 20° W 14.28 FEET TO BRASS NAIL AND WASHER "LS 2507" BETWEEN THE B AND T.

Location & Comments:

MONUMENT IS ON TOP OF RIDGE THAT RUNS SOUTH 70° WEST, AND WEST ±220' FROM CENTERLINE OF BURMA ROAD.

Surveyor's Stamp



Terry L. Jones
OREGON
JULY 25, 2017
TERRY L. JONES

RENEWAL DATE 6-30-17

Office Use Only

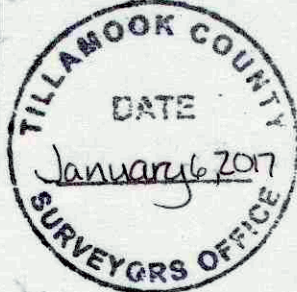

Firm/Agency:

BAYSIDE SURVEYING

Address:

11765 HWY 101 SOUTH
TILLAMOOK, OR 97141

Party Chief:

TERRY JONES

Notes:

FILE NAME rewitness\T3N-R7W-S7-SW.xls

Witness(es):

TLJ/DWE